



VESTIL MANUFACTURING CORP.
 2999 North Wayne Street, P.O. Box 507, Angola, IN 46703
 Telephone: (260) 665-7586 -or- Toll Free (800) 348-0868
 Fax: (260) 665-1339
 www.vestilmfg.com e-mail: info@vestil.com

ROLL-D Adjustable Drum Dollies Instruction Manual



Receiving instructions:

After delivery, remove the packaging from the product. Inspect the product closely to determine whether it sustained damage during transport. If damage is discovered, record a complete description of it on the bill of lading. If the product is undamaged, discard the packaging.

NOTE:

The end-user is solely responsible for confirming that product design, installation, use, and maintenance comply with laws, regulations, codes, and mandatory standards applied where the product is used.

Table of Contents

Specifications.....	2
Signal words.....	3
Safe use recommendations.....	3
Exploded parts diagram and bill of materials.....	3
Assembly instructions.....	4
Adjusting the dolly.....	5
Use instructions.....	5
Inspections & Maintenance.....	5
Labeling diagram.....	5
Limited warranty.....	6

Specifications:

Dimensions, net weight, and capacity information is presented below.

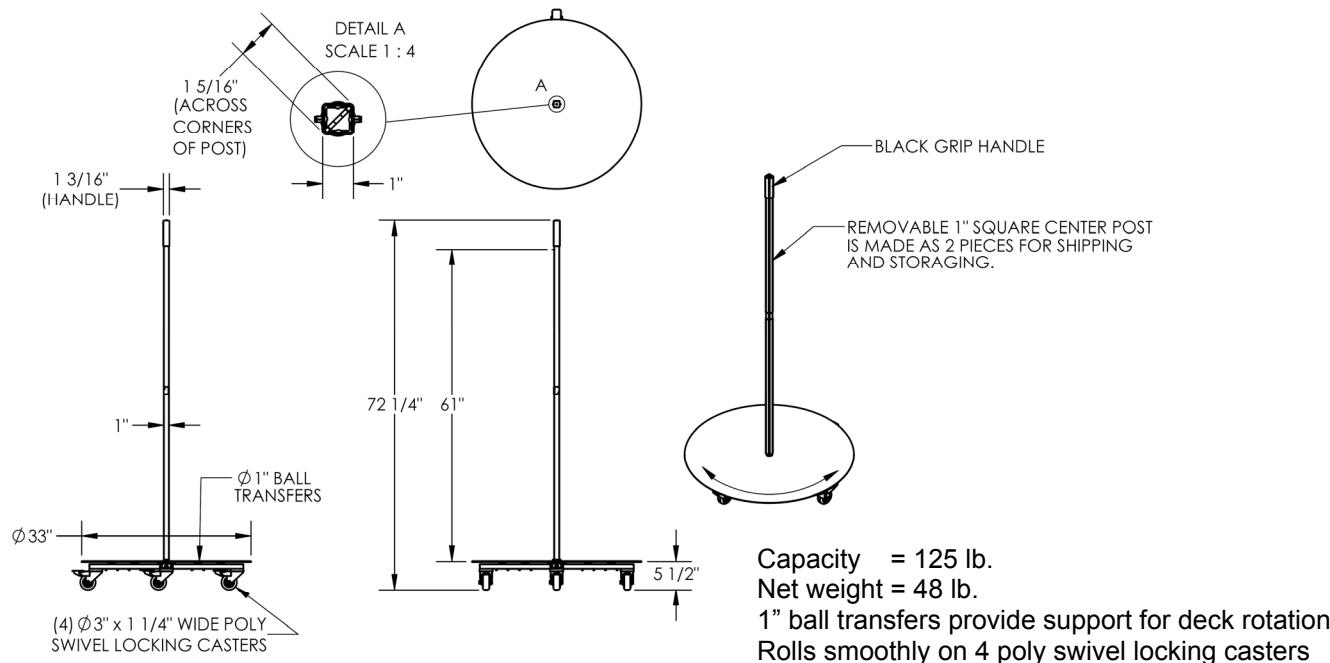

SIGNAL WORDS:

This manual uses SIGNAL WORDS to call attention to uses of this product that are likely to result in personal injuries or property damage. The signal words used in this manual appear below along with their definitions.

⚠ DANGER Identifies a hazardous situation which, if not avoided, **WILL** result in DEATH or SERIOUS INJURY. Use of this signal word is limited to the most extreme situations.

⚠ WARNING Identifies a hazardous situation which, if not avoided, **COULD** result in DEATH or SERIOUS INJURY.

⚠ CAUTION Indicates a hazardous situation which, if not avoided, **COULD** result in MINOR or MODERATE injury.

NOTICE Identifies practices likely to result in product/property damage, such as operation that might damage the product or other property.

Safe Use Recommendations:

Study the entire manual before using this product. Read the manual to refresh your understanding of the safe operation, inspection or maintenance procedures whenever necessary.

- ⚠ WARNING** Improper or careless operation might result in serious personal injuries.
- DO NOT use a damaged or malfunctioning dolly! Restore the dolly to normal operating condition before returning it to service. If the dolly cannot be repaired, destroy it or permanently remove it from service.
 - DO NOT exceed the capacity of your dolly (see "Specifications" section p. 2).
 - Keep feet and toes away from the casters whenever using the dolly to transport a barrel.
 - DO NOT use the dolly on angled surfaces. Only use the dolly to transport drums across even, level ground.
 - DO NOT use the dolly to move people. This product should only be used to transport barrels.
 - DO NOT ride on the dolly.
 - DO NOT use this product if any label is unreadable, damaged, or missing (see "Labeling diagram" on p. 4). Contact Vestil for replacement labels whenever necessary.
 - DO NOT modify the dolly! Modifications automatically void the limited warranty (see p. 5) and might make the dolly unsafe to use.

NOTICE This product must be maintained as instructed. Follow the recommendations provided in "Inspections & Maintenance" on p. 5.

ROLL-D Exploded Parts Diagram and Bill of Materials

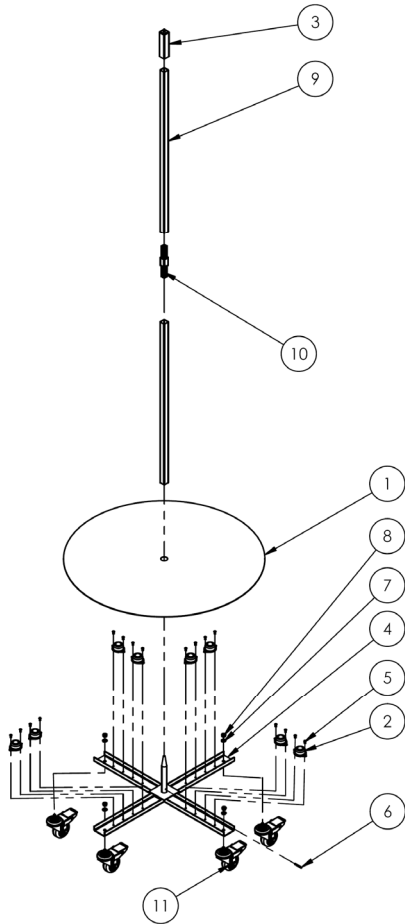

Item	Part no.	Description	Quantity
1	16-013-152	Deck, base, rotating	1
2	33-145-005	Specialty hardware, 1" ball transfer	8
3	99-025-027	Grip, 1" square tube cap	1
4	16-514-255	Weldment, frame, base	1
5	41125	Rivet, SB64 $\frac{3}{16}$ " x 0.250"	16
6	64137	Spring pin, AISI 1070-1095, plain finish, $\frac{3}{16}$ " x $1\frac{1}{2}$ "	1
7	33622	Split lock washer, carbon steel, medium zinc finish, $\frac{3}{8}$ "	4
8	36106	Hex nut, gr. A, zinc plated, $\frac{3}{8}$ "-16	4
9	16-014-516	Handle segment	2
10	44-516-024	Assembly, bracket, handrail splice	1
11	16-132-163	Caster, PP-3/1.25-STM-TTL	4

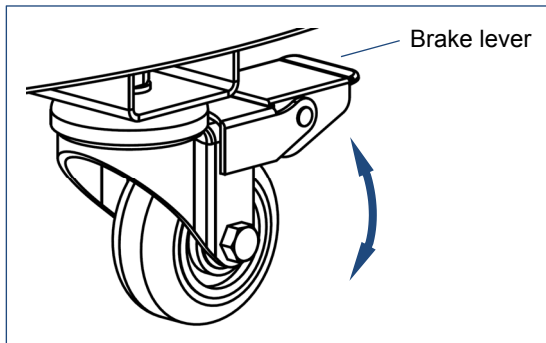

Assembly Instructions:

[Numbers in parentheses correspond to part numbers in the exploded parts diagram (above).]

Step 1: Slide the handle segment (9) without the handle grip (3) over the base peg. Then, insert the splice (10) into the upper end of the segment.

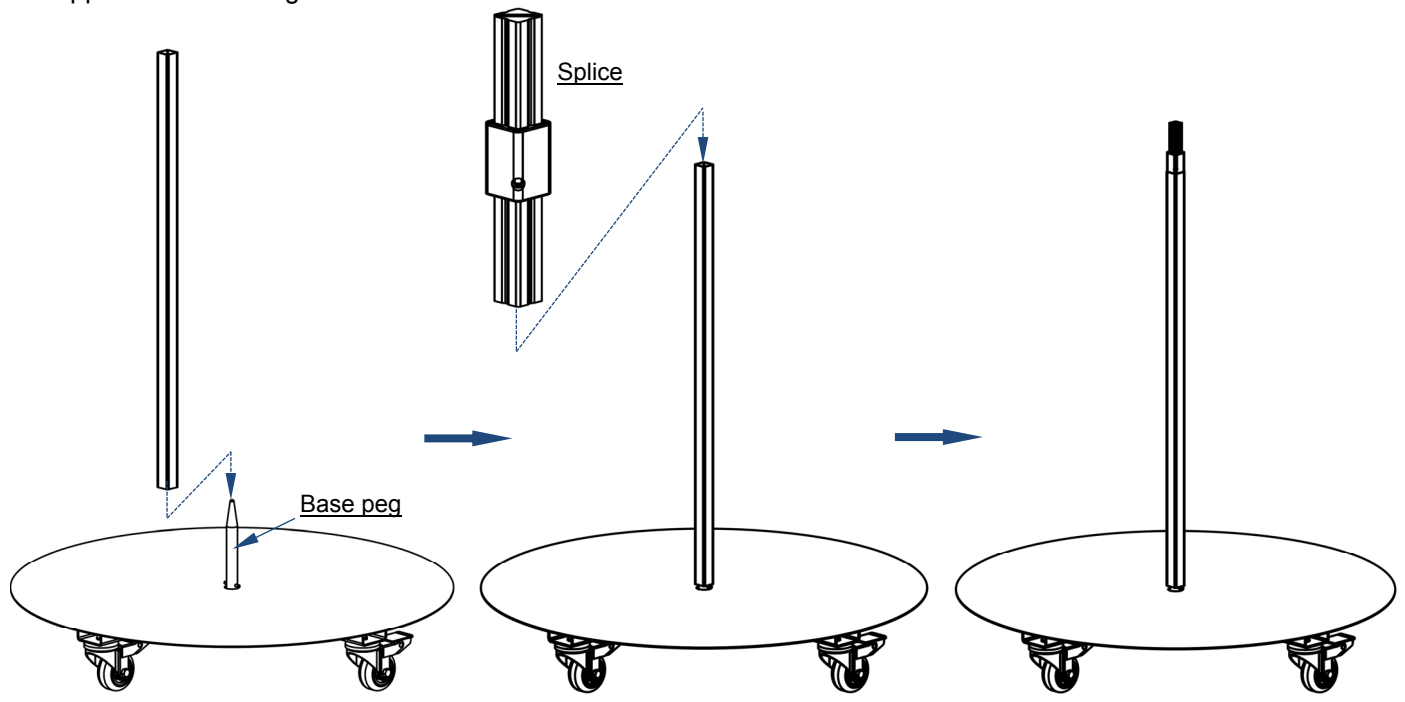

Step 2: Slide the second handle segment onto the free end of the splice. Then, use a ⁵/₁₆" hex key or Allen screwdriver to tighten the set screw of the splice. When the set screw is adequately tightened, the handle segments are firmly clamped in place and cannot slide off of the splice.

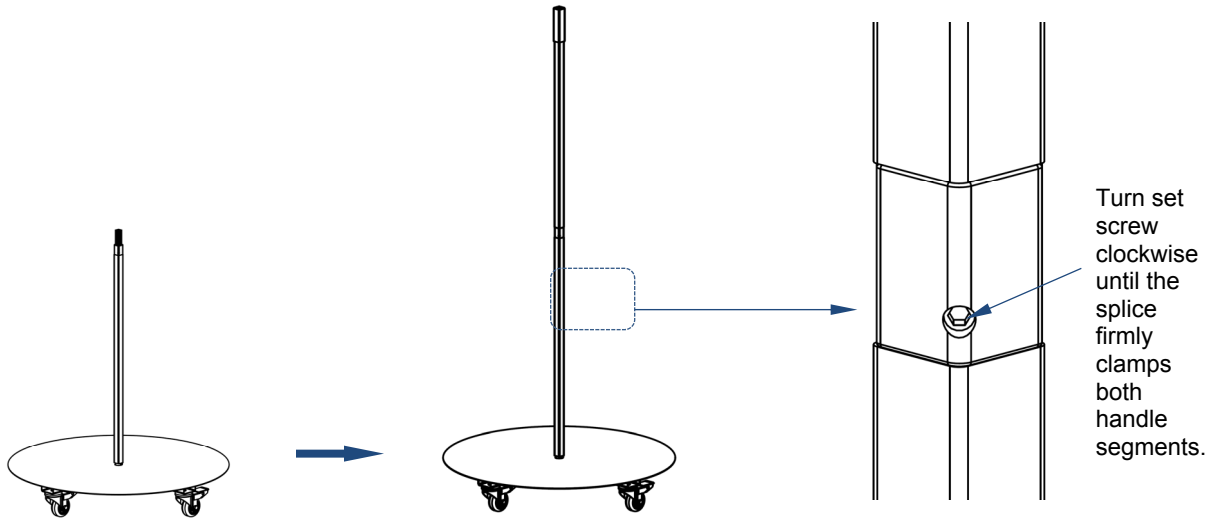

Use instructions:

Apply a roll of material to the dolly by sliding the center of the roll over the handle. When applying heavy rolls to the dolly, the upper part of the handle can be removed so that the roll doesn't have to be lifted as high. To remove the upper segment, simply turn the splice set screw counterclockwise until the clamp is released. Then, slide the segment off of the splice. Do not overload the dolly! The total weight applied to it must not exceed 125 pounds (see "Specifications" on p. 2).

Apply the caster brakes whenever the dolly is in use and not being moved. Apply the brakes by pressing down on the brake levers (see "Exploded Parts Diagram" on p. 3). Release the brakes by pressing the levers up.

Dispense material by pulling the cut end away from the dolly. The deck rotates as the roll spins.

Inspections & Maintenance:

Before using the dolly for the first time, make a written record that describes its appearance and operation. Rotate the deck. Include details about how easily the deck rotates as well as sounds heard while the deck rotates. This written record establishes "normal condition". During later inspections, compare your observations to the record to determine whether the dolly is in normal condition.

Examine the dolly at least once per month. Check the following components and compare their state to the written record. Replace any part that is damaged or severely worn with manufacturer-approved replacement parts.

1. Base frame – lay the dolly on its side and examine the base frame. Check for cracks, corrosion, etc. turn the deck and make sure that it spins easily.
2. Casters – each caster should roll smoothly without wobbling or binding. Tighten fasteners if necessary. When the brake of each caster is applied, it should prevent the wheel from rotating.
3. Handle and splice – confirm that the splice securely clamps both handle segments. The handle pieces should not be cracked, bent, or widened, particularly around the splice.

Labeling diagram:

Only use the dolly if it is labeled as diagrammed below. ALL labels must be readable and undamaged. Replace labels as necessary. Because the labels are not visible when it is loaded, we recommend making photocopies of the labels before putting the dolly into service. Display the photocopies in the location where the dolly is used.

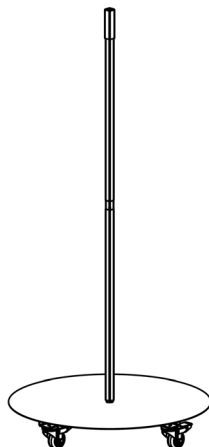

A: Label 658 (applied to deck)

⚠ WARNING Do not operate or move with unstable loads DO NOT LOAD beyond rated capacity DISTRIBUTE LOAD EVENLY DO NOT sit or ride	⚠ ADVERTENCIA No use a mueva con cargas inestables No cargue mas de la capacidad tasada DISTRIBUYA LA CARGA A NIVEL NO SE SIENTE o vaya en el carro	⚠ AVERTISSEMENT Ne pas utiliser avec une charge instable NE PAS CHARGER au-delà du débit nominale DISTRIBUER la charge régulièrement NE PAS VOUS ASSEoir OU VOUS PROMENER sur le c
---	--	---

B: Label 287 – (applied to deck)

MODEL/MODÉLO/MODÈLE _____

STATIC CAPACITY (evenly distributed) _____ lbs.

LA CAPACIDAD CONSTANTE (distribuida uniformemente) _____ kgs.

CAPACITÉ STATIQUE (distribuée régulièrement) _____ kgs.

SERIAL/SERIE/SÉRIE _____

287 REV 0812

C: Label 212 – (applied to deck)

⚠ WARNING LOCK CASTER and/or FLOOR LOCK when loading and unloading	⚠ ADVERTENCIA La RUEDECILLA de la CERRADURA y/o el PISO CIERRAN al cargar y descargar	⚠ AVERTISSEMENT LOCK CASTER et/ou SOL LOCK lors du chargement et de déchargement
--	---	---

212 Rev 0111

LIMITED WARRANTY

Vestil Manufacturing Corporation (“Vestil”) warrants product to be free of defects in material and workmanship during the warranty period. *Our warranty obligation is to provide a replacement for a defective original part if the part is covered by the warranty, after we receive a proper request from the warrantee (you) for warranty service.*

Who may request service?

Only a warrantee may request service. *You are a warrantee if you purchased the product from Vestil or from an authorized distributor AND Vestil has been fully paid.*

What is an “original part”?

An original part is a part used to make the product as shipped to the warrantee.

What is a “proper request”?

A request for warranty service is proper if Vestil receives: 1) a photocopy of the Customer Invoice that displays the shipping date; AND 2) a written request for warranty service including your name and phone number. Send requests by any of the following methods:

<u>Mail</u>	<u>Fax</u>	<u>Email</u>
Vestil Manufacturing Corporation 2999 North Wayne Street, PO Box 507 Angola, IN 46703	(260) 665-1339 <u>Phone</u> (260) 665-7586	sales@vestil.com

In the written request, list the parts believed to be defective and include the address where replacements should be delivered.

What is covered under the warranty?

After Vestil receives your request for warranty service, an authorized representative will contact you to determine whether your claim is covered by the warranty. Before providing warranty service, Vestil may require you to send the entire product, or just the defective part or parts, to its facility in Angola, IN. The warranty covers defects in the following original dynamic components: motors, hydraulic pumps, electronic controllers, switches and cylinders. It also covers defects in original parts that wear under normal usage conditions (“wearing parts”), such as bearings, hoses, wheels, seals, brushes, and batteries.

How long is the warranty period?

The warranty period for original dynamic components is 90 days. For wearing parts, the warranty period is 90 days. The warranty periods begin on the date when Vestil ships the product to the warrantee. If the product was purchased from an authorized distributor, the periods begin when the distributor ships the product. Vestil may, at its sole discretion, extend the warranty periods for products shipped from authorized distributors by *up to 30 days* to account for shipping time.

If a defective part is covered by the warranty, what will Vestil do to correct the problem?

Vestil will provide an appropriate replacement for any covered part. An authorized representative of Vestil will contact you to discuss your claim.

What is not covered by the warranty?

1. Labor;
2. Freight;
3. Occurrence of any of the following, which automatically voids the warranty:
 - Product misuse;
 - Negligent operation or repair;
 - Corrosion or use in corrosive conditions;
 - Inadequate or improper maintenance;
 - Damage sustained during shipping;
 - Accidents involving the product;
 - Unauthorized modifications: DO NOT modify the product IN ANY WAY without first receiving written authorization from Vestil. Modification(s) might make the product unsafe to use or might cause excessive and/or abnormal wear.

Do any other warranties apply to the product?

Vestil Manufacturing Corp. makes no other express warranties. All implied warranties are disclaimed to the extent allowed by law. Any implied warranty not disclaimed is limited in scope to the terms of this Limited Warranty.

